

Fitting your Single Pleated Screen, Reveal fit – Kit PL7**

Thanks for choosing our screen system.

We double check all orders before despatch, but we would ask you to check that all the components have been received as listed below. If any items are missing please call us on 01628 481919

If you are unsure at any stage please contact us. We are always happy to help.

Contents

Top track – 40mm deep

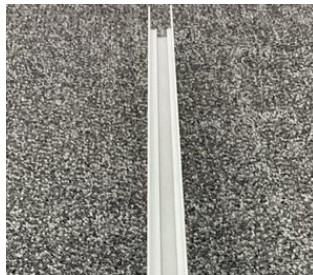

Bottom track – 4mm



2 Side Channels

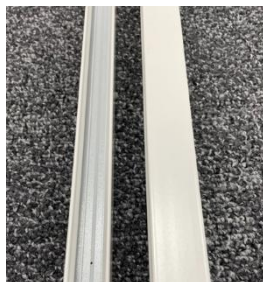

Corners for the top track



Corners for the bottom track



Silver Closing Carrier with magnetic strip insert



Mesh with handle bar

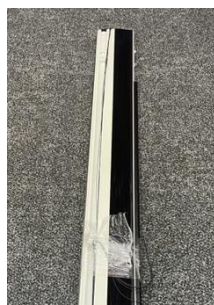

Allen Key

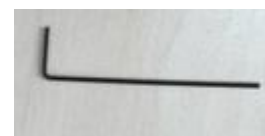

Side channel
fixing screws and
Rawl plugs



Screw Driver



2 D Handles and
fixing screws



Handle fixing
pads



Black tensioner
screws



Windproof clips
(if your screen is
over 1300mm
wide)



Windproof slider
(if your screen is
over 1300mm
wide)



Tools required

- Tape measure & pencil
- Spirit level
- Power drill
- 3 ½ mm drill bit – suitable for drilling aluminium
- 5 ½ mm masonry drill bit
- Posidrive 2 bit
- Allen key 2.5mm (**provided**)
- Pair of scissors

Overview

Your screen system consists of a single pleated mesh door which pulls across your opening, closing on to a magnetic strip on the opposing side. Top and bottom tracks create the seal within your door reveal.

The screen must be fitted square to ensure it functions correctly. If your reveal is not square you may need to 'pack out' and we would suggest this is done to the side profiles and top track rather than the bottom track.

Step 1 – Fitting the top track.



- Push the corners on to the end of the top track. The corners provide you with a few mm tolerance when fitting.
- Once you have decided on the position of the top track, within the recess, you may wish to mark this with a pencil.
- Peel the adhesive strip from the top of the track and corners and bond them to the underside of your reveal. The adhesive strip will hold the track firmly in place.

Step 2 – Fitting the bottom track.

- It is important to ensure that the bottom track is fitted directly beneath, and in line with, the top track. Draw a pencil line as a point of reference to fit the edge of the track to.
- Slot the bottom track corners on to both ends of the track piece. You will see that the prongs slot into the track.
- Remove the backing from the adhesive strip on the bottom of the track and corners and carefully position directly below the upper track. Push firmly down into place, ensuring the track is straight.

Step 3 – Fitting the first side channel.



- Pre-drill both side channels with 3½ mm holes down the back face, between the two ridges. One hole 100mm from either end then 2 more at equal distances between these.
- The groove running down the back edge of the channel allows it to slot on to the tab in both the top and bottom corners.

- Decide which side of your door you wish to mount the mesh. This is the side channel you need to fit first.
- Fit into the top corner first. Angle the channel on to the tab and push upwards. Then push the bottom of the channel into place.
- Mark the holes on your walls to correspond with the holes in your side channels. Remove the channel and drill with a 5 ½ mm drill bit and insert the Rawl plugs. If you are fitting to a wooden frame, you can use the screws provided (without the Rawl plugs) and fix straight into the wood without the need to mark, remove and drill.
- Re-fit the channel and screw into position.

Step 4 – Fitting the Mesh

- Take the cling film off the mesh and remove the cardboard from around the strings.
- Ensure the strings are exiting the unit without being caught in the end cap at the top and the bottom.
- The top of the mesh is the end with the tensioner. See image below.
- The silver edge of the mesh fits into the side channel. Position the mesh with the silver part facing the channel. Lift it up into the top track holding the strings towards the middle of the screen. Lower until it sits on the bottom track with the strings coming from under the mesh towards the middle of the screen.
- Position the mesh up against the side channel. **Starting from the bottom** gently pull the mesh away from the silver metal element and push the unit into the channel. As you move upwards you will start to hear it clip into position

Top of fitted mesh

Bottom of fitted mesh

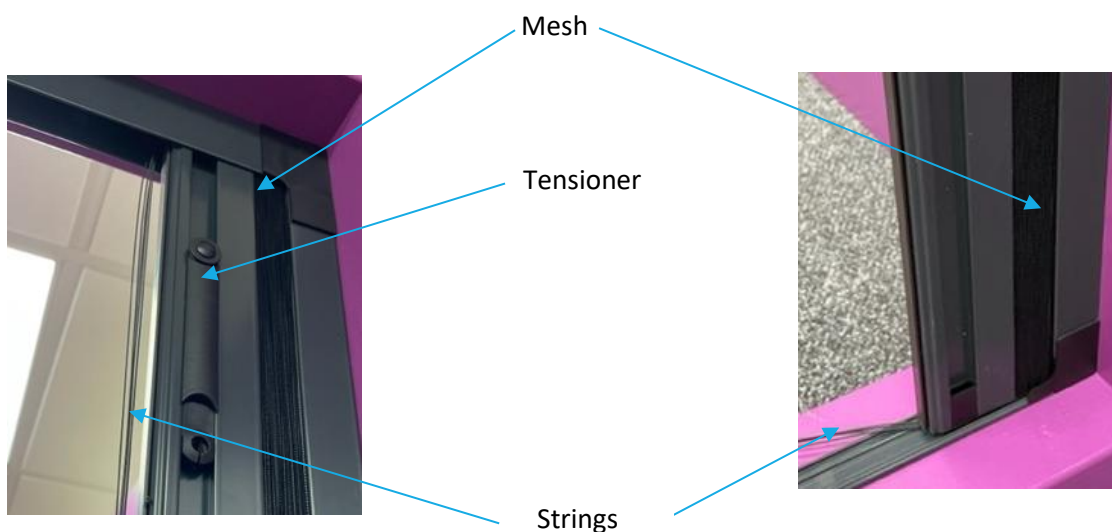

Step 5 – Fitting the strings

- Check the strings are running freely on the top and bottom of the mesh by holding each of the group of strings in turn in one hand and pulling the handlebar slightly toward the centre with the other hand. The strings will move if they are free. Push the mesh back to the side. If the mesh does not move freely, you can ease the handle bar out of the tracks to check the top and bottom 'end plugs' to make sure the strings are not trapped.
- At the end of each set of strings, top and bottom, there is a square plastic 'tuner' these hold the strings at the correct length for a smooth operation. Insert the tuner into the top and bottom corner respectively ensuring that the head of the little screw in each case can be seen. See red arrows in diagram 2 below.

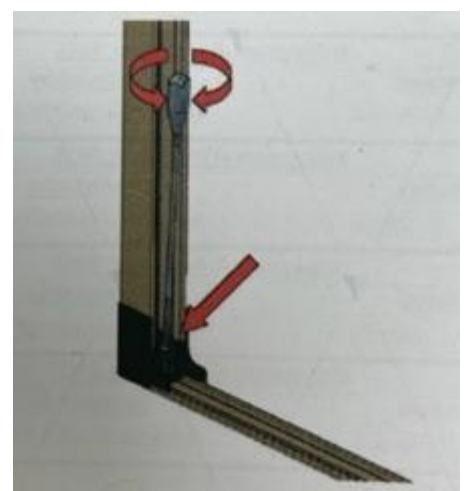
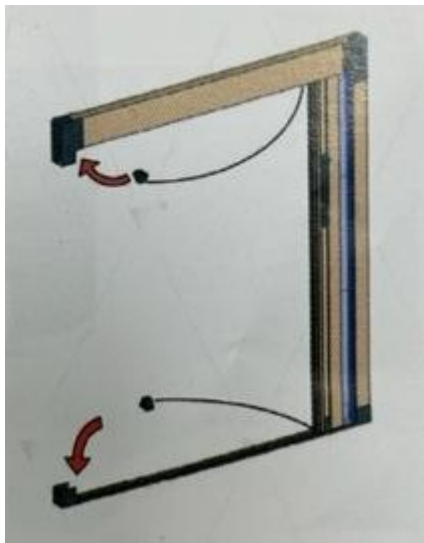

- Now test the screen by pushing the handle bar over to the closed position. If it runs smoothly then the string tension is correct and the strings are running freely.
- If the strings are not free refer to the first bullet point of this section. If the tension is too tight / loose you may need to adjust the strings. Use the screwdriver in the fixing pack and turn the screw to the left/right. See the third diagram above. We would suggest making an adjustment to the top strings first and then test to see if that corrects the issue. If not, you may need to make adjustments to the bottom strings. Make incremental adjustments until the issue is resolved and you have a smooth flowing movement when closing/opening the screen.
- Once you are happy with the tension you can cut the strings leaving about 8cm length.

Step 6 – Fitting the second side channel.

- As with the first side channel fit into the top corner first. Angle the channel on to the tab and push upwards. Then push the bottom of the channel into place.



- As per step 3 mark the holes on your walls to correspond with the holes in your side channels. Remove the channel and drill accordingly. Re-fit and screw into place. Make sure the ends of the strings remain in front of the channel.

Step 7 – Fitting the closing carrier with magnetic strip.

- The grey strip in the silver channel is the magnetic closing strip. You firstly need to check the polarity of this by putting it up against the handle bar on your mesh. If it does not magnetise to the handle bar turn it upside down and re-test. Now you know which way round it needs to be.
- Take the carrier over to the opposing end and with the silver back of the closing carrier facing the side channel angle in the bottom corner first. As you did with the mesh, position the carrier up against the side channel. **Starting from the bottom** push the unit into the channel. As you move upwards you will start to hear it clip into position. Ensure the ends of the strings are now behind the carrier.
- Test the screen once more.

Step 8 - Finishing touches!

Now you can complete the finishing touches to the screen

- Push tensioners on the handle bar (front and back) upwards so that the wheel touches the top track. Screw the black tensioner screws into the hole at the bottom to hold it in place. See image on next page



Step 9 – Attaching the handles.

The handle bar has a groove running down its length which naturally acts as a handle and gives a minimalistic look to the screen, but there are also 2 black D shaped handles included with your system. If you wish to attach these please find instructions below.

- Place the handle fixing pad into the groove within the handle bar at the position you would like to fit the handle (usually in the middle of the height to ensure the screen is pulled across evenly)

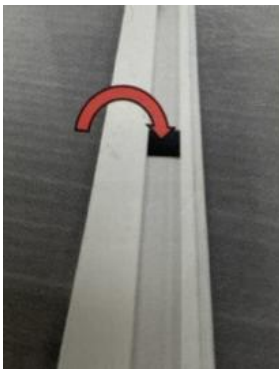

- Place the handle on to the handle bar with the rounded edge of the D facing the side of the screen with the mesh and the middle screw hole over the fixing pad.



- Push the top and bottom ends of the handle into the groove on the handle bar and then screw the handle to the pad with the black screws provided, see images on previous page. Do not overtighten the screw.

Step 10 – Windproof clips (if your screen is over 1300mm wide)

In the vast majority of installations these are not required so you may wish to start using the screen and see if you need to fit them, however, if you are in a particularly exposed location you may wish to fit from the start.

- Position the clips evenly across the top of the mesh starting approx. 20cm from either end.
- Close the screen and push the mesh gently out of the top track where you wish to position a clip.
- On one of the mesh folds position the clip with the prong protruding above the top of the mesh and clip the back plate in place on the other side of the mesh. The shiny side of the back plate should face away from the mesh. See drawings below.

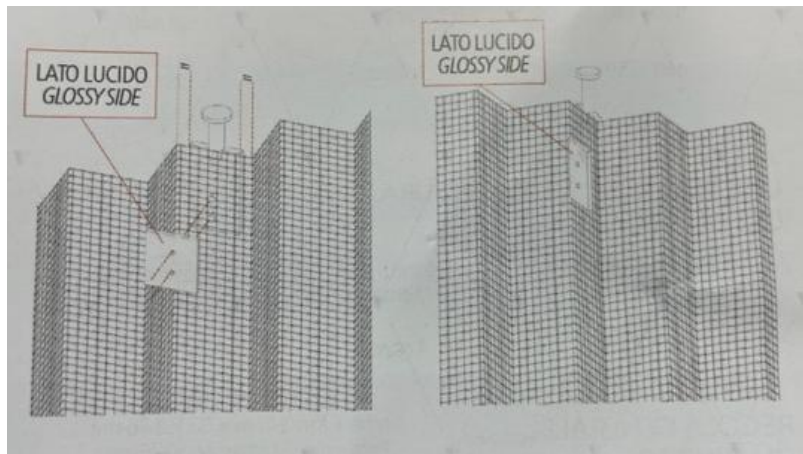

- Before you replace the mesh insert the slider into the top track. You can use the screw driver to assist with positioning the insert. See drawings below.

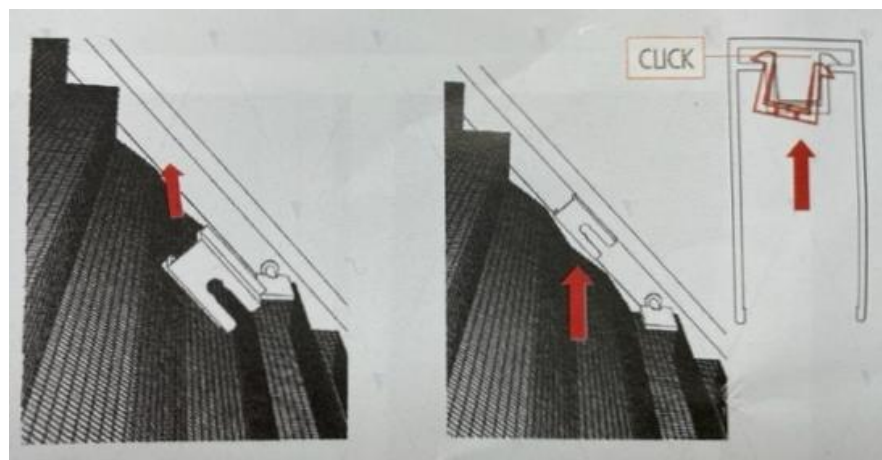

- Push the mesh back into the top track and slide the protrusion on the clip into the slider until it clicks. See images below

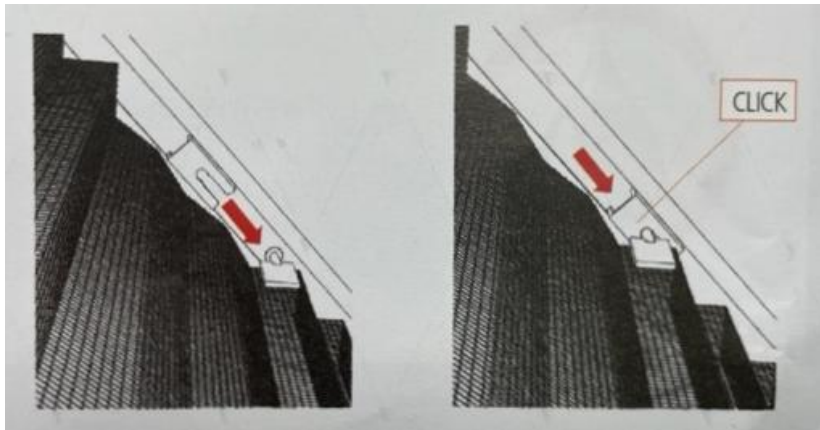

Step 11 – Additional information

- Once you have finished your installation you can spray the top and bottom track with silicone which will assist with the smooth gliding movement of the screen.
- Keep the bottom track free of debris by hoovering on a regular basis using the round furniture attachment and wipe with a damp cloth. This will ensure the continued smooth running of your screen.
- The mesh can also be brushed or hoovered using the round furniture attachment. It is recommended that you gather the mesh together slightly whilst doing this.

YOUR INSTALLATION IS COMPLETE